

Vemer S.p.A.

I - 32032 Feltre (BL) • Via Camp Lonc, 16
Tel +39 0439 80638 • Fax +39 0439 80619
e-mail: info@vemer.it - web site: www.vemer.it

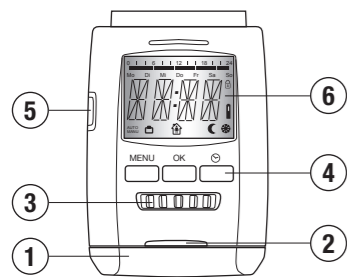

2 DISPLAY AND MENU



- Batteries compartment;
- Sensor temperature;
- Selector wheel;
- Function keys: MENU – OK – ☺;
- Mini-USB connector for PC.ThermoPro connection;
- Display LCD
- Area with the 4 alphanumeric digits;
- Profile indicators: comfort/economy ranges day and time;
- "Child protection" function indicator;
- Battery replacement indicator;
- System active indicator;
- ECONOMY active indicator;
- COMFORT active indicator;
- "Holiday" active indicator;
- AUTO or MANUAL mode active indicator

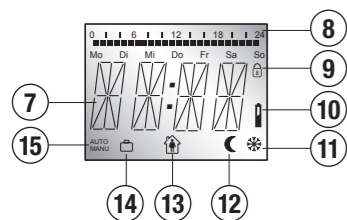

Programming menu

By pressing **[MENU]** key you will arrive at the programming menu. With the selector wheel you navigate among the eleven choices described here below:

MODE to select **AUTO** mode (automatic) or **MANU** (manual)

PROG setting and programming of environment profiles

TEMP setting of COMFORT temperature (Tmax) and ECONOMY (Tmin)

TIME setting of current date and time

WINW setting of function parameters "open window"

RES reset of the initial factory programming (Reset)

ADAP start of adaptation cycle to valve

HOLI setting of "holiday" function

INST setting of installation/removal of chronothermostat

OFFS setting of "offset" temperature

STBY setting of "standby" function

VERS information version Sw product

DST daylight saving time

Error messages

| Error | Cause | Solution |
|-------|--|---|
| E1 | No adaptation possible. | Install ThermoPro on the valve. |
| E2 | The valve stroke is too short. | Open and close the valve several times manually or replace the batteries. |
| E3 | Motor movement is not possible. Does the valve stem move freely? | |

3 INSTALLATION

Inserting/replacing batteries

To access the battery compartment, make lever with your finger on the hook of the battery lid as shown in the picture. Insert two AA 1.5V alkaline batteries of long life, paying attention to the indicated polarity.

Warning: use only alkaline batteries!; do not use rechargeable batteries.

Setting time and date

At first inserting the batteries, you must enter the date and time. Use the selector to set the value and OK to confirm. The sequence of values is: year, day, month, time, minutes.

--> For next changes press **[MENU]** and with the selector choose TIME.
--> In case of battery replacement date and time are not lost.

ThermoPro, after a preparation phase (indicated on the display by PREP), prepares itself in INST mode. In this condition it can be installed on the valve.

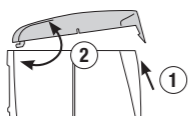

1 User manual

CHRONOTHERMOSTATS FOR RADIATORS

⚠ Read all instructions carefully

Weekly chronothermostat designed for installation on thermostatically-controlled valves and for the adjustment of environment temperature.

| Code | Model | Description |
|-----------------|--------------|---------------------------------------|
| VE740700 | ThermoPro | Weekly chronothermostat for radiators |
| VE742300 | PC.ThermoPro | Programming key |

SAFETY WARNINGS

During product installation and operation it is necessary to observe the following instructions:

- The instrument must be installed by a qualified person.
- Do not install the instrument if any part of it is damaged.

TECHNICAL SPECIFICATIONS

- Power supply: 2 x 1.5V batteries (AA type)
- Battery life: 5 years (with depleted batteries indication)
- Regulation type: PID with a response time lower than 3 minutes
- Operation:
 - automatic, with two levels of temperature (comfort and economy)
 - manual, with temperature set using the selector wheel
- Maximum number of daily switchings: 4 in comfort and 4 in economy
- Operating temperature: 0 ÷ 50 °C
- Storage temperature: -20 ÷ +70 °C
- Protection degree: IP30
- Dimensions (WxHxD): 52x83x65 mm
- Compatible valve connections:
 - valves with thread measure dimensions of M30x1.5 (Heimeier, Junkers Landys+Gyr, MNG, Honeywell, Braukmann,...)
 - Danfoss RAV, RA, RAVL

Adapter

| No adapter | + plastic stem | | |
|---|--|------------|--------------|
| valves with thread measure dimension of M30X1.5 | Danfoss RAV (plastic stem must be plugged on the valve tapped) | Danfoss RA | Danfoss RAVL |

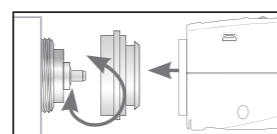

valve – coupling ring

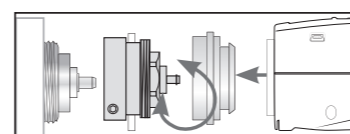

valve – adapter – coupling ring

Installation on the valve

ThermoPro can be installed on any type of thermostatically-controlled valve shown in technical specifications, without the need to interrupt the heating circuit. The installation takes place via the coupling ring and, in some cases, with the use of the appropriate adapters.

- Unscrew the manual thermostatic head and remove it from the valve
 - Choose, if necessary, a suitable adapter and fix it to the valve
 - Screw the coupling ring
 - Insert ThermoPro in the coupling ring until it clicks in confirmation of hooking.
- Warning: do not apply excessive efforts in fixing ThermoPro on the coupling ring. Always make sure that during the installation the ThermoPro is in INST position.

Adaptation to the valve

Press **[MENU]** key and scroll with the wheel until the display shows ADAP. Press **[OK]**: the ThermoPro will be able to start the adaptation to the valve. This operation may take a few minutes. After successful adaptation, the device returns to normal mode.

--> If you need a new adaptation, repeat the procedure.

--> If you receive the error message E2, remove the batteries for a short period in order to reset the device.

Removing the ThermoPro

To remove the ThermoPro go to ON of the menu (**[MENU]** --> TEMP --> ON) and wait for a short period. Then press the quick release button on the device and pull ThermoPro out of the ring coupling.

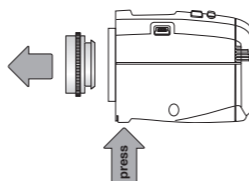

4 OPERATION

Setting of a program (AUTO)

You can set 4 periods of comfort and 4 periods of economy each day. You can set a different program for each day of the week or a common programming to several days (grouping):

D1-5 = same program from Monday to Friday

D1-6 = same program from Monday to Saturday

D1-7 = same program from Monday to Sunday

For unplanned days remains active the factory program (switching in comfort at 06:00 o' clock and switching in economy at 22:00 o'clock).

- Press **[MENU]**, with the selector choose PROG and confirm with **[OK]**. The display shows DAY 1 (Monday).
- With the selector choose the desired day (or a grouping) and confirm with **[OK]**. On the display flashes the time of the first switching in COMFORT.
- With the selector set the time and confirm with **[OK]**. On the display flashes the time of the first switching ECONOMY.
- With the selector set the time and confirm with **[OK]**. Proceed with the setting of the other switchings. Switchings in COMFORT and ECONOMY not activated are displayed as "--:--".



Advanced functions and operations

TIMER FUNCTION

With ThermoPro it's possible at any time to exclude for a settable interval of time the automatic program.

- Press the key **[☺]**, on the display flashes the value of the minimum timing 1H;
- With the selector, set the desired timing between a minimum of 1H and a maximum of 24H and confirm with **[OK]**
- On the display flashes the set temperature, with the selector, set the value of desired temperature and confirm with **[OK]**.

During operation in TIMED mode, the selector wheel and the keys **[OK]** and **[☺]** are inactive. To cancel the TIMED system, press the key **[MENU]**.

OFFSET

It's possible that shelves, curtains, etc.. near the radiator hamper correct detection of the environment temperature. In this case it's possible to enter a correction factor OFFSET:

- Press **[MENU]**, choose OFFS and press **[OK]**
- On the display flashes the Offset temperature
- With the selector, set the desired correction factor and confirm with **[OK]**.

Example: If the temperature on the chronothermostat is 21°C but the temperature detected in the environment is only 19°C, enter a correction factor of +2.0°C.

WINDOW FUNCTION

If you open a window and consequently the temperature drops significantly, ThermoPro closes the valve for a settable time in order to save energy; during this time, the display shows the symbol ANTIFREEZE.

- Press **[MENU]**, select WINW
 - On the display flashes the set sensitivity MID; with the selector, set the sensitivity of desired detection: HIGH = High, MID = Average, LOW = Low. Confirm with **[OK]**.
 - On the display flashes the set closure time 10M (10 minutes); with the selector, set the desired timing and confirm with **[OK]**.
- At the end of the timing the chronothermostat returns to normal operation.

HOLIDAYS FUNCTION

In case of prolonged absences, you can set the date and time of return and the temperature you desire to set for this period of absence:

- Press **[MENU]**, select HOLI and confirm with **[OK]**
- On the display flashes the current date, for example: 6:01 (GG.MM); set the return date and confirm with **[OK]**.
- On the display flashes the entire time after the current one; with the selector, set the return time and confirm with **[OK]**.
- On the display flashes OFF (valve closed, i.e. the factory programming); with the selector, as an alternative to the closed valve, you can set the desired temperature; confirm the final choice with **[OK]**.

On the display appears the set temperature or the chosen valve status (OFF closed, ON open) together with the symbol holidays (☺).

HEATING INTERRUPTION (VALVE CLOSURE)

If necessary, you can close the valve and turn off the heating of the room:

- Press **[MENU]**, select MODE and confirm with **[OK]**.
 - On the display flashes MANU and confirm with **[OK]**.
 - With the selector, lower the temperature until OFF appears and confirm with **[OK]**.
- Even if the valve is closed, the anti-calcification function remains activated. To deactivate the function switch to the AUTO mode.

- If you do not want to program other switchings press **[OK]** until starts the programming of the next day. To exit the programming, press **[MENU]**.

Setting comfort and economy temperature

The factory settings provide the following values: ECONOMY = 16°C COMFORT = 21°C. The minimum and maximum setting limits are: OFF = antifreeze function active (8°C) ON = valve fully open

- Press **[MENU]**, with the selector choose TEMP and confirm with **[OK]**. On the display flashes the set COMFORT temperature.
- With the selector set the temperature and confirm with **[OK]**. On the display flashes the set ECONOMY temperature.
- With the selector set the temperature and confirm with **[OK]**.

If the ThermoPro is in AUTO mode, manual setting of the temperature will be maintained until the next change of system, after which the chronothermostat will operate according to the defined profile.

CHILD LOCK FUNCTION

This function disables the keys and the selector wheel, in order to prevent access to the menu by unauthorized persons.

- Press simultaneously the keys **[OK]** and **[☺]** for 2 sec. until symbol padlock (🔒) appears. To remove the lock, operate in a similar manner until the symbol padlock (🔒) disappears.

FACTORY CONFIGURATION RESET

- Press **[MENU]**, select RES and confirm with **[OK]**.
- On the display flashes OK, confirm with **[OK]** or press **[MENU]** to exit the function without canceling the programming.

ANTI-FREEZE FUNCTION

If the environment temperature falls below 6 °C, the chronothermostat opens the valve until the temperature rises to 8°C in order to prevent water freezing in the pipes.

CALCIFICATION PROTECTION FUNCTION

Once per week (Friday), ThermoPro performs a cycle of opening and reclosing valve to prevent the phenomenon of calcification.

DISPLAY OFF

- Press **[MENU]**, select STBY and confirm with **[OK]**.
- On the display flashes the word OFF, select ON and confirm your choice with **[OK]**. After 30 sec. the display turns off and on again by pressing a key or by operating on the selector wheel, then it turns off after 30 seconds. To deactivate the function, proceed as above, but select the option OFF.

WINTER-SUMMER TIME CHANGE

- Press **[MENU]**, select DST and on the display flashes OFF (winter time now).
- Select the option ON (summer time now) and confirm with **[OK]**. Proceed as above for change from summer time to winter time.

Programming by PC.ThermoPro

ThermoPro key programmer permits a quick and easy graphical programming on your PC. The Mini USB connector, that is supplied along with the product, allows you to download programs between programmer and ThermoPro. The mini-USB connector present on the product is compatible only with the cable of the PC.ThermoPro programmer; do not connect other devices with Mini-USB port to prevent the irreversible damage of the chronothermostat.



REFERENCE STANDARDS

Compliance with Community Directives:
2004/108/EC (E.M.C.)
is declared in reference to the harmonized standards:
• EN 60730-2-7, EN 60730-2-9

